



TESTA MULTIPROFILO PER STONDARE O SMUSSARE REGOLABILE

Adjustable multi-profile head for rounding or chamfering

Verstellbarer Multiprofilkopf für kanten oder abrunden
Cabezal multiperfil regulable para redondear o biselar

COLTELLI DA ORDINARE A PARTE

The knives must be ordered separately

Die Messer sind separat zu bestellen

Cuchuiillos a pedir aparte



CODICE CODE	MATERIALE MATERIAL	D mm	B mm	d mm	Z	ROTAZ. ROTAT.
AT04001	ACCIAIO	160	45	40	4	R
AT04002	ACCIAIO	160	45	40	4	L
AT04003	ACCIAIO	160	60	40	4	R
AT04004	ACCIAIO	160	60	40	4	L
AT04005	ACCIAIO	160	16	40	4	R
AT04006	ACCIAIO	160	16	40	4	L

DISTINTA BASE / Bill of Materials								
DESCRIZIONE DESCRIPTION	DIMENSIONI mm	CODICE CODE	CODICE AT040					
			01	02	03	04	05	06
Cuneo / Wedge	43 x 12 x 8 DX	CU085	4	/	/	/	/	/
Cuneo / Wedge	43 x 12 x 8 SX	CU086	/	4	/	/	/	/
Cuneo / Wedge	58 x 12 x 8 DX	CU036	/	/	4	/	/	/
Cuneo / Wedge	58 x 12 x 8 SX	CU037	/	/	/	4	/	/
Cuneo / Wedge	15 x 12 x 8 DX	CU038	/	/	/	/	4	/
Cuneo / Wedge	15 x 12 x 8 SX	CU039	/	/	/	/	/	4
Vite per Cuneo / Wedge's Screw	M8 x 16	VT005	8	8	8	8	/	/
Vite per Cuneo / Wedge's Screw	M8 x 10	VT015	/	/	/	/	4	4
Vite di Riferimento / Positioning Screw	M5 x 7 Ø16	VT012	4	4	4	4	4	4
Set Anelli / Set Rings	d40 x 42	SA014	1	/	1	/	1	/
Chiave per Cuneo / Wedge's Key	Esagonale 4	CH004	1	1	1	1	1	1

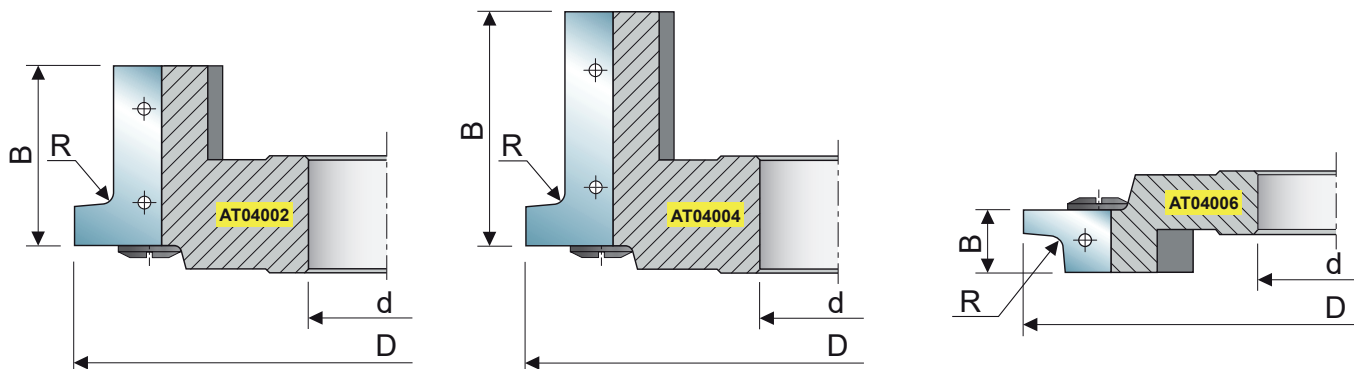

ESEMPI DI LAVORAZIONE
Working Example

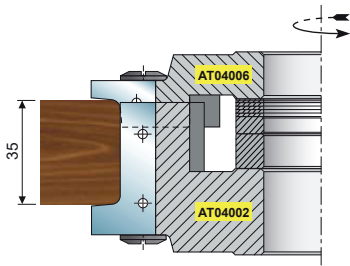

L max = 35 mm

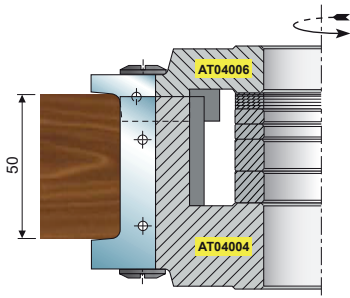

L max = 50 mm

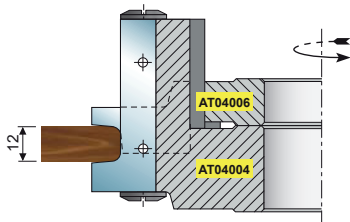

L min = 12 mm

COLTELLI STANDARD / Standard Knives								
DESCRIZIONE DESCRIPTION	DIMENSIONI mm	CODICE CODE	CODICE AT040					
			01	02	03	04	05	06
Coltello R3 / Knife R3	45 x 25 x 3 DX	CSAT026	4	/	/	/	/	/
Coltello R3 / Knife R3	45 x 25 x 3 SX	CSAT027	/	4	/	/	/	/
Coltello R5 / Knife R5	45 x 25 x 3 DX	CSAT028	4	/	/	/	/	/
Coltello R5 / Knife R5	45 x 25 x 3 SX	CSAT029	/	4	/	/	/	/
Coltello R8 / Knife R8	45 x 25 x 3 DX	CSAT030	4	/	/	/	/	/
Coltello R8 / Knife R8	45 x 25 x 3 SX	CSAT031	/	4	/	/	/	/
Coltelli a 45° / Knife at 45°	45 x 25 x 3 DX	CSAT032	4	/	/	/	/	/
Coltelli a 45° / Knife at 45°	45 x 25 x 3 SX	CSAT033	/	4	/	/	/	/
Coltello R3 / Knife R3	60 x 25 x 3 DX	CSAT034	/	/	4	/	/	/
Coltello R3 / Knife R3	60 x 25 x 3 SX	CSAT035	/	/	/	4	/	/
Coltello R5 / Knife R5	60 x 25 x 3 DX	CSAT036	/	/	4	/	/	/
Coltello R5 / Knife R5	60 x 25 x 3 SX	CSAT037	/	/	/	4	/	/
Coltello R8 / Knife R8	60 x 25 x 3 DX	CSAT038	/	/	4	/	/	/
Coltello R8 / Knife R8	60 x 25 x 3 SX	CSAT039	/	/	/	4	/	/
Coltelli a 45° / Knife at 45°	60 x 25 x 3 DX	CSAT040	/	/	4	/	/	/
Coltelli a 45° / Knife at 45°	60 x 25 x 3 SX	CSAT041	/	/	/	4	/	/
Coltello R3 / Knife R3	16 x 25 x 3 DX	CSAT042	/	/	/	/	4	/
Coltello R3 / Knife R3	16 x 25 x 3 SX	CSAT043	/	/	/	/	/	4
Coltello R5 / Knife R5	16 x 25 x 3 DX	CSAT044	/	/	/	/	4	/
Coltello R5 / Knife R5	16 x 25 x 3 SX	CSAT045	/	/	/	/	/	4
Coltello R8 / Knife R8	16 x 25 x 3 DX	CSAT046	/	/	/	/	4	/
Coltello R8 / Knife R8	16 x 25 x 3 SX	CSAT047	/	/	/	/	/	4
Coltelli a 45° / Knife at 45°	16 x 25 x 3 DX	CSAT048	/	/	/	/	4	/
Coltelli a 45° / Knife at 45°	16 x 25 x 3 SX	CSAT049	/	/	/	/	/	4

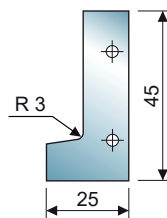

CSAT027

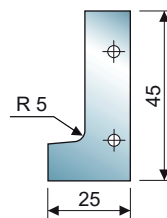

CSAT029

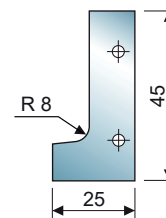

CSAT031

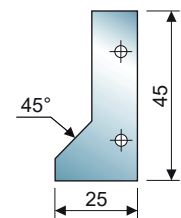

CSAT033

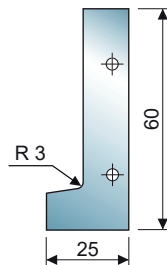

CSAT035

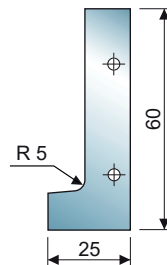

CSAT037

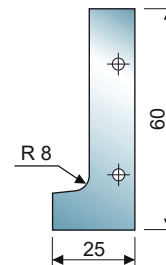

CSAT039

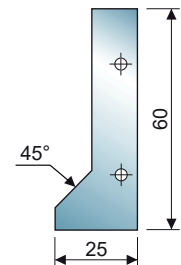

CSAT041

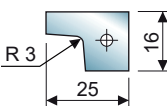

CSAT043

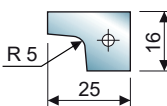

CSAT045

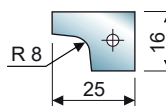

CSAT047

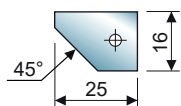

CSAT049